



DE GUZMAN & CO.

QUICK START GUIDE

DG018 CHRONOGRAPH HYBRID

MOVEMENT: TIME MODULE INC. (SEIKO INSTRUMENTS INC.) VK64

The DG018 is a hybrid mechanical-quartz movement that utilizes a quartz timekeeping movement while using a mechanical module fitted on top of the movement for the chronograph function. The chronograph sweeps like a mechanical chronograph, while keeping the time-keeping aspect accurate as with a quartz movement. This makes the DG018 function differently from our previous predecessors that only use a mechanical (automatic) movement.

THE PARTS

HIGHLIGHTS IN BLUE ARE FOR CHRONOGRAPH AND SPECIAL FUNCTIONS

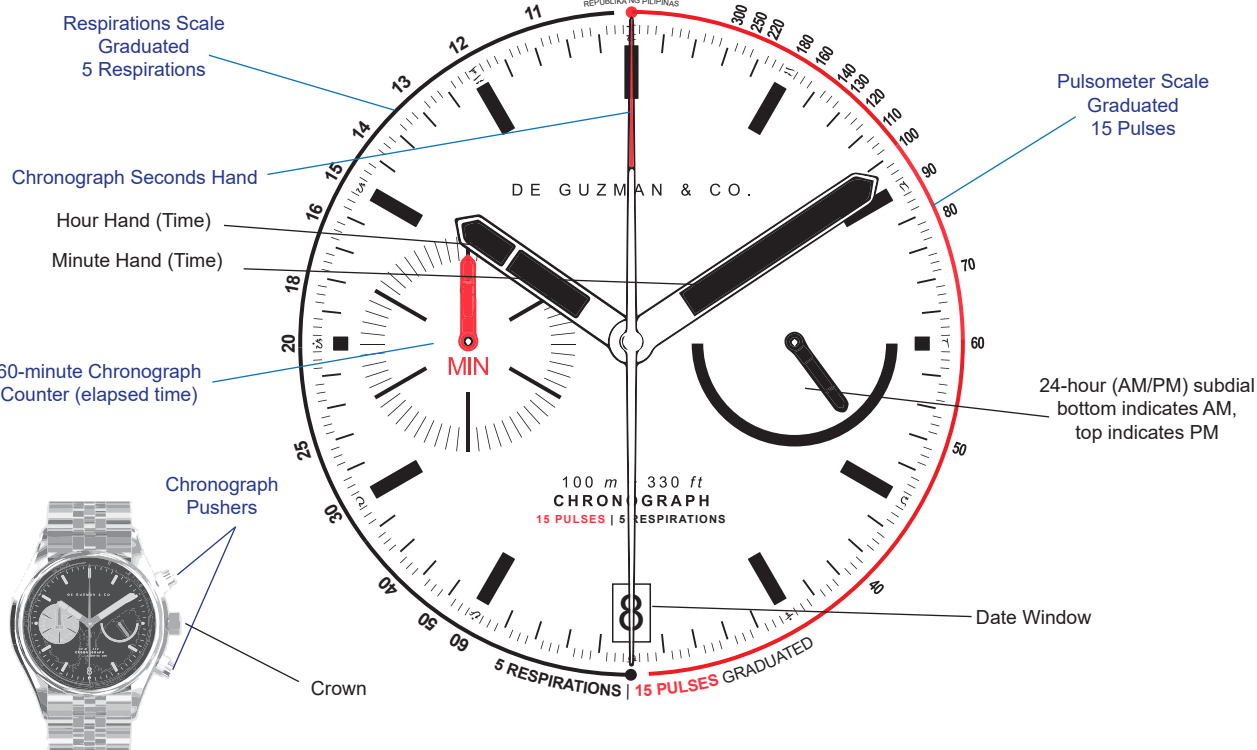

BASIC FUNCTIONS (CROWN)

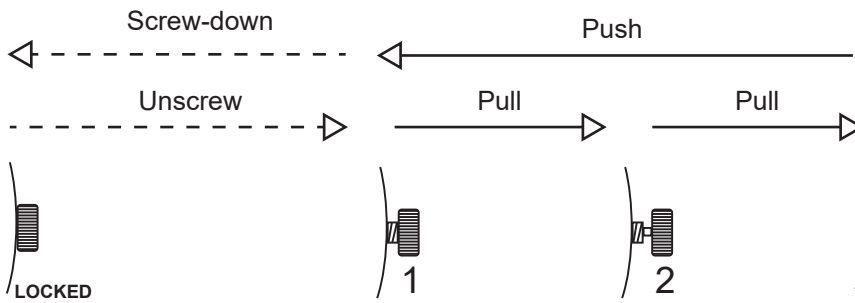

LOCKED POSITION
Water resistance is maintained ONLY when the crown is in the locked position (screwed-in). Unscrew by rotating the crown counter-clockwise.

NOTICE:
Always keep the crown screwed-in (locked) to prevent water ingress and damage to the movement.

NEUTRAL
Position 1 is right after unscrewing the crown. No functions in this position.

NOTICE:
Please refrain from keeping the crown in this position. ALWAYS keep the crown screwed-in to maintain water resistance.

DATE SETTING
Position 2 is when the crown is pulled ONCE. This allows setting of the date.

WARNING:
Do NOT set the date between 9:00 pm and 3:00 am to prevent damage to the movement mechanism

TIME SETTING
Position 3 is when the crown is pulled TWICE. This allows setting of the time.

CHRONOGRAPH FUNCTIONS (PUSHERS)



START / STOP Chronograph

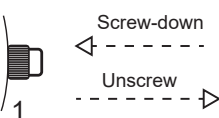

START CHRONOGRAPH
While the chronograph is stopped. PRESS ONCE to start the chronograph.

↓ ↑ PRESS

POSITION 1 LOCKED POSITION
Water resistance is maintained ONLY when the pusher is in the locked position (screwed-in). Unscrew by rotating the pusher counter-clockwise.

NOTICE:
Always keep the pusher screwed-in (locked) to prevent water ingress and damage to the movement.

STOP CHRONOGRAPH
While the chronograph is running, PRESS ONCE to STOP/PAUSE the chronograph hand to track the elapsed time (up to 60 minutes)

RESET Chronograph

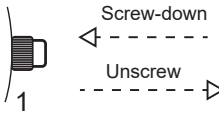

RESET CHRONOGRAPH
While the chronograph seconds hand is stopped. PRESS ONCE to RESTART the chronograph back to 0.

READING THE CHRONOGRAPH EXAMPLE

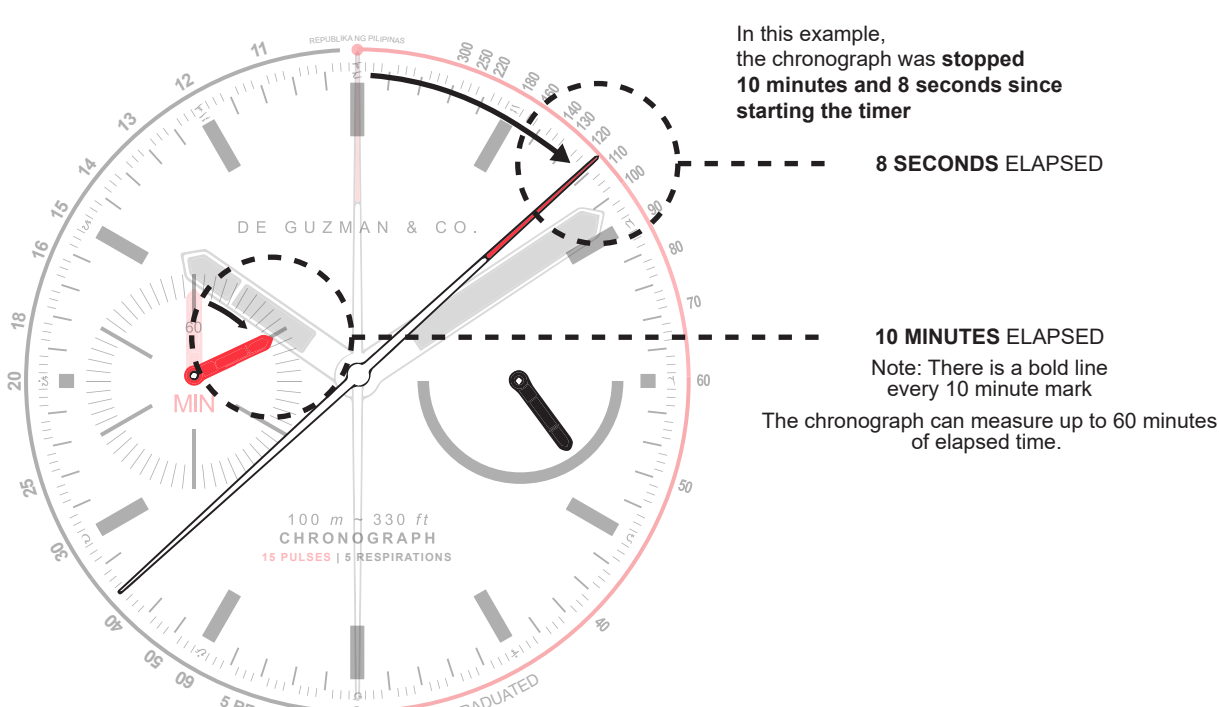

SPECIAL FUNCTIONS 15 PULSES | 5 RESPIRATIONS SCALE

Found on the outer-ring, the DG018 possesses a special approach in measuring both pulses and respirations using its double edged chronograph hands. This is used to measure and give an approximation of a persons pulse rate and respiratory rate. A valuable tool used in the field of medicine.*

*De Guzman & Co. does not advertise the DG018 as a medical device nor as a replacement for proper medical equipment.

RESPIRATORY RATE (RR)

Prepare measuring the person's breath (respiration).

START the chronograph at the start of each breath.

Count 5 breaths.

STOP the chronograph once 5 breaths have been counted.

Check outer-ring for the approximate respiratory rate of the person.

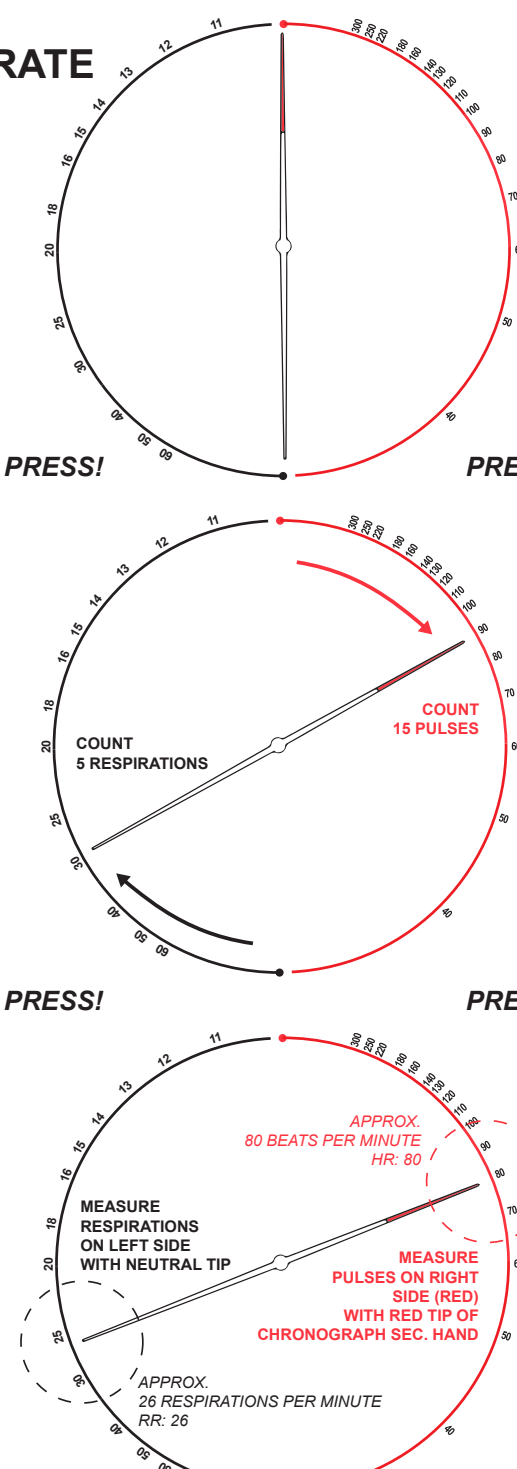

PULSE RATE (HR)

Prepare getting the person's pulse.

START the chronograph at the start of a pulse.

Count 15 pulses.

STOP the chronograph once 15 pulses have been counted.

Check outer-ring for the approximate pulse rate of the person.