



DE GUZMAN & CO.

QUICK START GUIDE

DG009 GMT MOVEMENT (HZ6460GMT)

SETTING THE TIME, DATE, AND SECOND TIME ZONE

The DG009 with GMT movement allows the tracking of multiple time zones (up to three) with the use of its 24-hour GMT hand. You may use the GMT hand as an AM/PM indicator by setting it to the 24-hour time in your current timezone. If tracking a second timezone is desired, the independently adjustable GMT hand can be set to your time zone of choice, referencing the inner bezel as your 24-hour time in your second time zone. A third timezone can also be tracked by rotating the bezel to your desired third timezone.

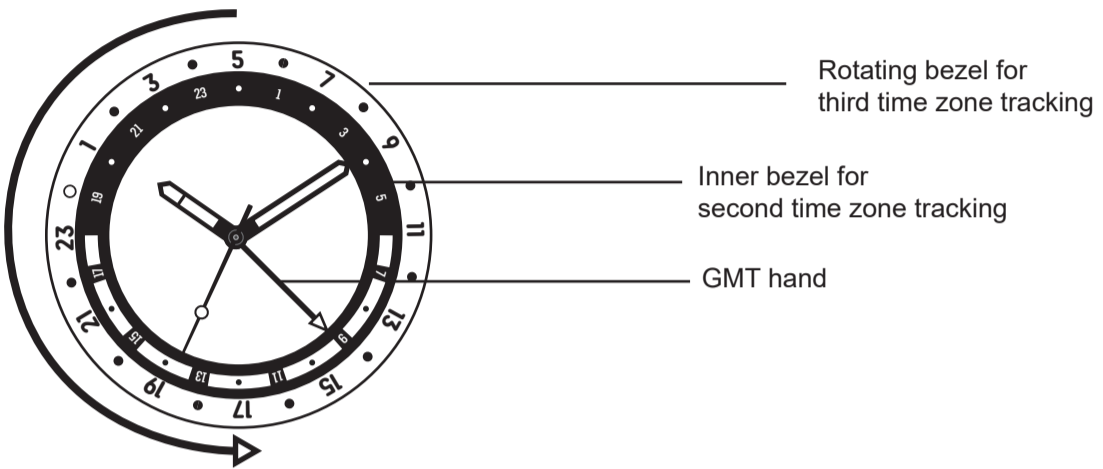

Rotatable unidirectional bezel counter-clockwise

Example diagram above: Local time at 10:10 AM, second time zone at 9:10 AM, third time zone 2:10 PM

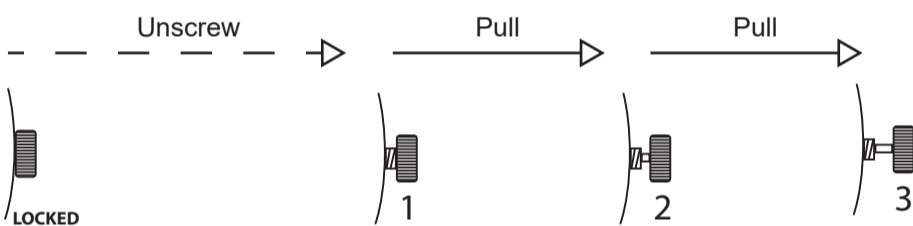

Water resistance is ensured ONLY when the crown is in locked position (screwed-in)

NOTICE:
Always keep the crown screwed-in to prevent water ingress and damage to the movement

HANDWINDING
Position 1 is right after unscrewing the crown. This allows handwinding of the automatic movement

NOTICE:
If the movement has lost power (i.e. watch has not been used for a while), Wind the movement by rotating the crown clockwise approx. 20-30 times

DATE and GMT SETTING
Position 2 is when the crown is pulled ONCE. This allows setting of the date (clockwise) and GMT time (counter-clockwise) when rotated

WARNING:
Do not set the date between 9:00 pm and 3:00 am to prevent damage to the movement mechanism

TIME SETTING
Position 3 is when the crown is pulled TWICE. This allows setting of the time.

ADJUSTING THE BRACELET

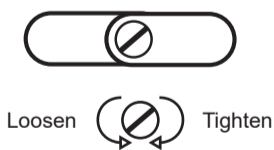

BRACELET ADJUSTMENT
Bracelet adjustments can be done using a screwdriver through the screw links found at the side of each bracelet link.

For a finer adjustment, use the adjustment pins on the side of the clasp

WARNING:
Do not overtighten the screw links to prevent stripping.

DG009: 1.0mm screwdriver

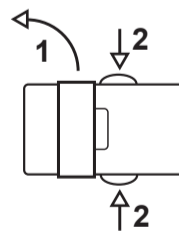

USE OF CLASP
DG009
1: Flip open the flip-lock keeper
2: Press both buttons to release the clasp